



ECOLAB

### Model number

#### VAZ-T1-FK-G10-3M-PUR-V1-GV4A

G10 junction block, AS-Interface to 1x M12 round plug connector with stainless steel cap nut

### Features

- One piece housing
- Simple and fast mounting
- Stainless steel version, especially suitable for applications in the food industry
- Gold-plated and machined contacts
- Oil and abrasion resistant PUR line appropriate for drag chains
- Immunity to vibration
- Degree of protection IP68 / IP69K
- Halogen-free

### Dimensions

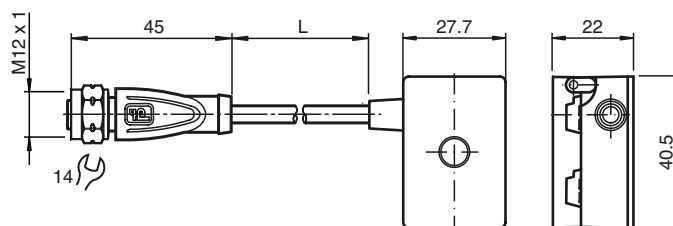

### Electrical connection

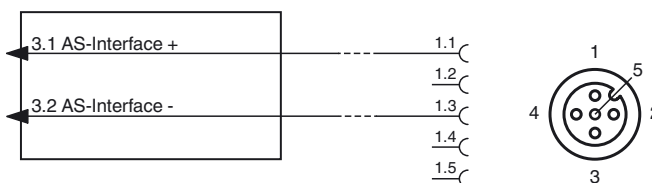

### Technical data

#### General specifications

Construction type	Socket, straight Flat cable terminal AS-Interface
UL File Number	E223772 "For use in NFPA 79 Applications only"

#### Electrical specifications

Rated operating voltage	$U_e$	$\leq 32 \text{ V PELV (AS-Interface)}$
Rated operating current	$I_e$	$\leq 4 \text{ A}$
Protection class		III
Surge protection		overvoltage category III

#### Ambient conditions

Ambient temperature	-25 ... 75 °C (-13 ... 167 °F)
Storage temperature	-25 ... 85 °C (-13 ... 185 °F)
Pollution degree	3

#### Mechanical specifications

Degree of protection	IP67 IP67 / IP68 / IP69K with flat cable VAZ-FK-S*
Connection	Flat cable AS-Interface: cable piercing method Plug connection: M12 x 1 socket (V1)

#### Material

Contacts	CuSn / Au
Housing	PBT PC
Body	black PUR
Cable	PUR
Slotted nut	stainless steel 1.4404 / AISI 316L
Mounting screw	Stainless steel 1.4305 / AISI 303

#### Cable

Sheath diameter	Ø4,3 mm
Color	black
Cores	2 x 0.5 mm <sup>2</sup>
Length	L 3 m
Mass	75 g
Tightening torque, fastening screws	1.65 Nm
Note	The unused flat cable connector is closed with a seal.

#### Compliance with standards and directives

Standard conformity	
Degree of protection	EN 60529:2000

#### Approvals and certificates

UL approval	cULus Listed, Type 1 enclosure
-------------	--------------------------------

Maximum permissible operating current  $\leq 3\text{ A}$

Maximum permissible ambient temperature  $\leq 55\text{ °C}$  ( $\leq 131\text{ °F}$ )

## Notes

### Mounting instructions

You may screw the device onto a level mounting surface using two M4 attachment screws. The attachment screws are not included.

